

Lampiatta 11"

STILNOVO

Decorative Pendant

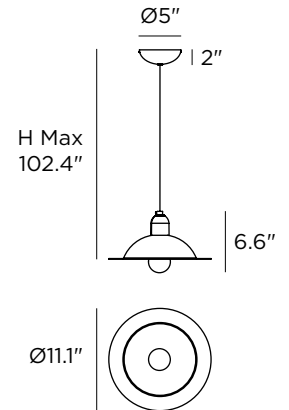

Technical data

Designer	De Pas - D'urbino - Lomazzi
Origin year	1971
Installation	4" Octagonal Junction Box
Environment	Indoor
Power	1 x 7 W
Lamp	1 x E26 LED
Voltage	120VAC
Optics	General Lighting
Light emission direction	Downward and upward
IP	IP20
Dimmable	Yes
Directional	No
Tilting	No
Cable included	Yes
Cable length	98.4"
Cable color	Black
Net weight	1.6 lbs

Lamping (not included)

Recommended Lamp(s)	1 x 7W E26 A19 3000K 90CRI IF EX. SATCO S29811
Nominal lamp lumens	806 lm
Color temperature	3000 K
Color rendering index	90 CRI

Fixture

Material	Aluminum
Finish	Powder Coating

Item

Item #	Color
8983	White RAL 9016
8984	Black RAL 9005
8985	Red RAL 2002
8981	Yellow RAL 1003
8982	Green RAL

Underside of shade always White RAL 9016
 Canopy always Black RAL 9005 except on White fixture
 canopy White RAL 9016